

Over this summer, we have been asking you, the users of Roberts Park, to tell us what you like about the Park and to suggest improvements. Your comments have helped us to develop designs for the restored landscape and buildings and to understand the kinds of activities people would like to take part in there.

Your key ambitions for the Park are summarised as follows:

- Repairs to the buildings and infrastructure.
- Off-site information on events and facilities in the Park.
- More signs, leaflets and displays in the Park, explaining its history, facilities etc.
- Toilets open from dusk till dawn.
- A café serving hot drinks, sandwiches and snacks.
- On the disused bowling greens, some of the following:
 - oversized games, such as chess and jenga;
 - a lawn with flower borders, to be cared for and developed by a gardening club and / or school groups;
 - a herb garden;
 - an international garden.

- A park manager, providing a visible presence outside in the Park; organising management and maintenance; providing information on events and facilities in the Park; and sharing knowledge of the Park's history and plants.
- The following events and facilities:
 - a play area for children of all ages, with adventure equipment, swings and slides and climbing nets;
 - canoes / rowing on the river;
 - themed walks, particularly history, nature and a riverside walk;
 - equipment on loan for group games;
 - learning packs for visiting educational groups;
 - sheltered areas for sitting, eating packed lunch etc;
 - outdoor art and sculpture;
 - a wide range of music concerts.
- No vehicle parking in the Park.
- A reduction in perceived and actual antisocial behaviour.

The plan below shows how we have incorporated these aspirations into the final designs for the restored Park. We hope these will allow your continued enjoyment of Roberts Park for years to come.

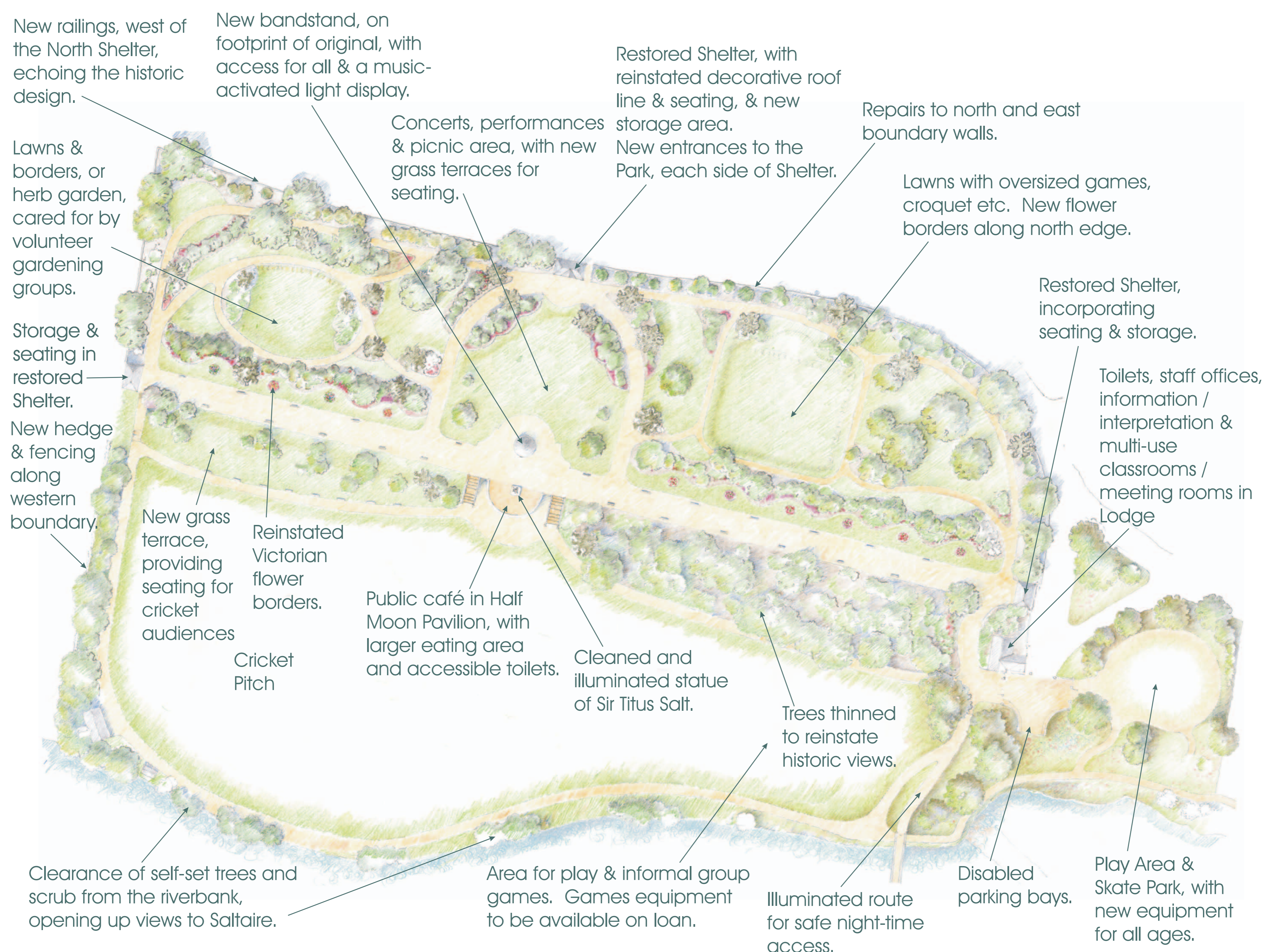

And throughout the Park:

- New benches, following the original, Victorian design.
- New waste bins.
- Repaired infrastructure, including drains and resurfaced paths.
- New interpretation and orientation signs.
- High quality horticulture and tree-care.
- Trees and shrubs thinned to reinstate historic views.

We hope that these improvements, along with a range of new activities and entertainments, as suggested by Park users during consultation, will make Roberts Park a safer, more inviting, colourful, beautiful and exciting place to visit; and ensure a long and happy future for this important element of Saltaire World Heritage Site.